

公差 (mm)		公差 (mm)		公差 (mm)		公差 (mm)		公差 (mm)		公差 (mm)		公差 (mm)		公差 (mm)		公差 (mm)													
0	>3	>6	>10	>18	>30	>50	>80	>120	>180	>250	>315	>400	>500	0.1/10		±2													
~	3	~	6	~	10	~	18	~	30	~	50	~	80	~	120	~	180	~	250	~	315	~	400	~	500				
±0.12		±0.18		±0.22		±0.26		±0.31		±0.37		±0.57		±0.80		±0.93		±1.05		±1.15		±1.60		±2.20		±2.50			

管 中 心  
研 发 专 用  
2020.03.19  
(仅限内部使用, 对外无效)

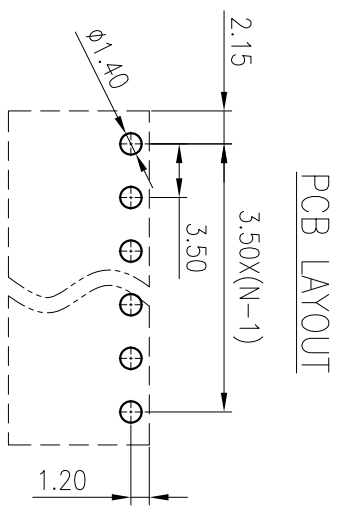
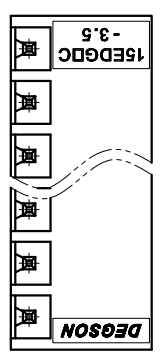
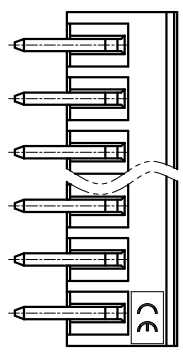
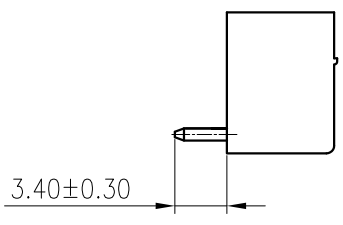
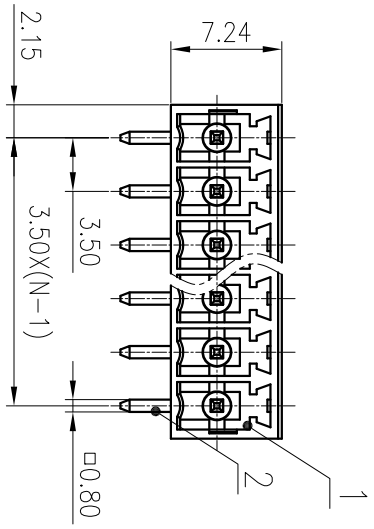
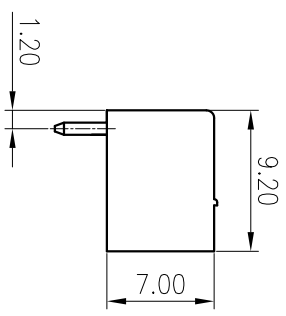
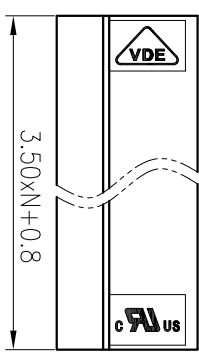

PCB LAYOUT

REV	ECN	DESCRIPTION	DRFT	DATE
(1)		Drawing Update	GenK	2020.03.19

MATERIAL:					
MAT NO.:	/				
STATUS:	/				
APPD:	Lan CHH	2020.03.19			
CHKD:	Yu JZh	2020.03.19			
DRFT:	YZ	2015.10.12			
SIZE:	A4				
TYPE:	CUSTOMER DRAWING				
SCALE:	2:1				
SHEET	1/1				

宁波高松电子有限公司  
NINGBO DEGSON ELECTRICAL CO., LTD

15EDGRC-3.5-XXP-1Y-00A(H)

ITEM	NAME OF PART	MATERIAL	NOTES
2	Pin	Copper Alloy	Sn Plated
1	Housing	PA66	UL94V-0

UL 标准/UL Standard:	B	C	D
额定电压/电流/Rated Voltage(V)/Current(A)	300/8	/	300/8
IEC 标准/IEC Standard:			
过压类别/Overvoltage Category/污染等级/Pollution Degree	II/2		
额定电压/电流/Rated Voltage(V)/Current(A)	250/7		
额定脉冲电压(KV)/Rate Impulse Voltage(KV)	2.5		
间距/Pitch(mm)/线数范围/Poles	3.50/N=02~24P		
使用温度范围/Operating temperature(°C)	-40~+105		
符合RoHS环保要求/Conform to RoHS	Yes		