

Wiring diagram

POWER SUPPLY ELECTRIC VEHICLE

- L1 2.5mm² Brown
- L2 Spare
- L3 Spare
- N 2.5mm² Blue
- PE 2.5mm² Yellow/Green
- RC=680Ω±3%
- PP
- CP 0.75mm² Red

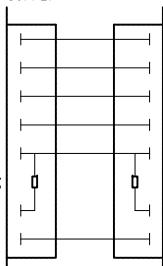

- L1 2.5mm² Brown
- L2 Spare
- L3 Spare
- N 2.5mm² Blue
- PE 2.5mm² Yellow/Green
- RC=680Ω±3%
- PP
- CP 0.75mm² Red

X1

Laser Printing Front Note:

 Laser Printing Back Note(Arial);
 MEAC-S-016A-P1-03-5.0M-30AH
 16A 250V AC
 IEC 62196-2:2016
 IP54
 20xxxxxx-xxxx

X2

Laser Printing Front Note(Arial);
 MEAC-S-016A-V1-03-5.0M-30AH
 16A 250V AC
 IEC 62196-2:2016
 IP54
 20xxxxxx-xxxx
 Laser Printing Back Note:

未注公差/General tolerances(mm)											D 0.1/10		
0 ~ 3	>3 ~ 6	>6 ~ 10	>10 ~ 18	>18 ~ 30	>30 ~ 50	>50 ~ 80	>80 ~ 120	>120 ~ 180	>180 ~ 250	>250 ~ 315		>315 ~ 400	>400 ~ 500
±0.12	±0.18	±0.22	±0.26	±0.31	±0.37	±0.57	±0.80	±0.93	±1.05	±1.15	±1.60	±2.20	±2.50

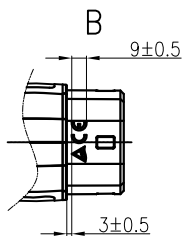
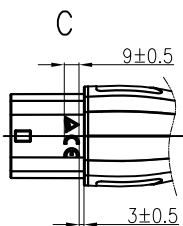
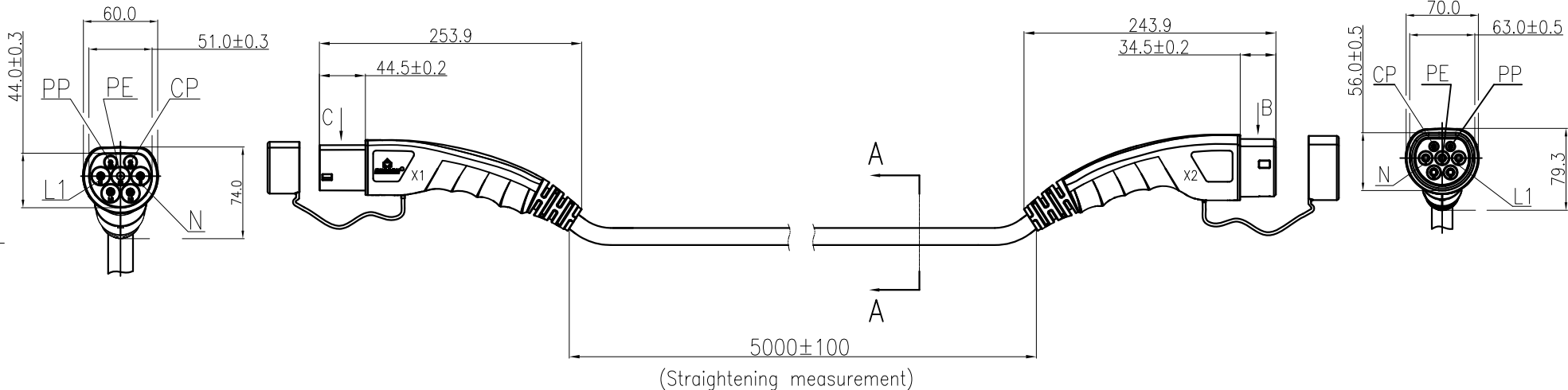
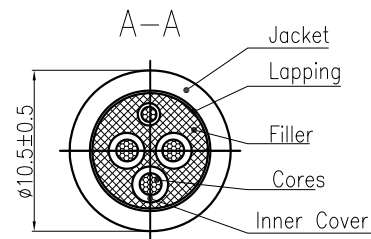

额定电压电流/Rated Voltage/Current	250V AC/16A
绝缘电阻/Insulate Resistance	>100MΩ,500V DC 1min
耐压/Withstanding Voltage	L、N and PE ,2500V AC 1min L and N ,2500V AC 1min
防护等级/Ingress Protection	IP54
插拔寿命/Insertion/Pullout Times	10,000 Times
插拔力/Insertion/Pullout Force	<100N
使用温度范围/Operating temperature(°C)	-30~+50
线材规格/Cable specification	3*2.5mm ² +1*0.75mm ² Black
标准/Reference standard	IEC 62196-2:2016
符合RoHS环保要求/Conform to RoHS	Yes

		MATERIAL:	SURFACE/COLOR:		
MAT NO/REV: DO-1		MAT STATUS:			
APPD: Ye DB	2024.07.09	NAME MEAC-S-016A-V1P1-03-5.0M-30A(H)			
CHKD: Dong RT	2024.07.09	DRAWING NO.			
DRFT: Hu MY	2024.07.09	TYPE	CUSTOMER DRAWING	DRAWING STATUS	SCALE
A4					1:3
				SHEET	1/1

REV	ECN	DESCRIPTION	DRFT	DATE

Transfer or duplication of this document as well as the utilization or concrete application of its contents are prohibited, unless written authorization is granted. All rights reserved for patent, copyright and other intellectual property rights. 复制或翻印本文件内容、未经授权擅自应用其内容均属于侵权行为。本公司保留所有权利。 复制、翻印、应用本文件内容未经本公司书面许可，均属侵权行为。 所有权利保留。