

Technical characteristics:  
 Specifications  
 DIN EN 60 664-1  
 DIN EN 61 984

Inserts

01. Number of contacts : 2
02. Rated Current : 70A
03. Rated Voltage : 1000V
04. Pollution degree : 3
05. Rated impulse voltage : 8kv
06. Insulation resistance :  $\geq 10^{10} \Omega$
07. Material: Polycarbonate
08. Color: RAL7032 (Light grey)
09. Rated voltage acc. to UL/CSA: 600V
10. Limiting temperatures : -40°C ~ +125°C
11. Flammability acc. to UL94: V0
12. Mechanical working life (mating cycles) :  $\geq 500$

Contacts

01. Material: Copper alloy
02. Surface: Silver plated
03. Contact resistance :  $\leq 1m\Omega$
04. Terminal : Crimp terminal
05. Wire gauge : 10~25mm<sup>2</sup> (AWG 8~4)
06. Stripping length : 15mm
07. Rohs Compliance
08. General tolerances: DIN ISO 2768-c

Note: Crimp contact pins should order separately

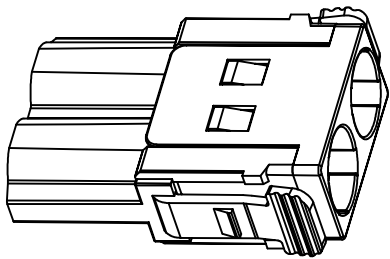
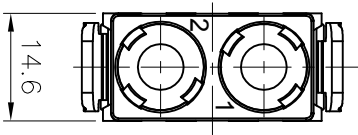
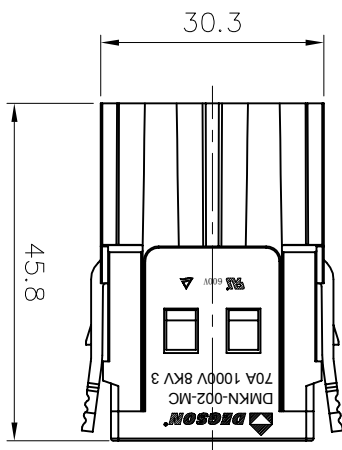
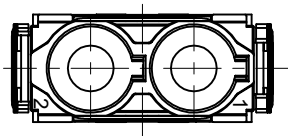

REV	ECN	DESCRIPTION	DRAFT	DATE

		MATERIAL:	/	SURFACE/COLOR:	/
APPD:		MAT NO./REV:	/	MAT STATUS:	/
CHKD:		NAME:	<b>DMKN-002-MC</b>		
DRAFT:	Yu Kiv 2023.08.17	DRAWING NO.:	/	TYPE:	CUSTOMER DRAWING
	A4	DRAWING STATUS:	/	SCALE:	1:1
	1000 inch	DRAWING STATUS:	/	SHEET:	1/1